

KEY PLAN

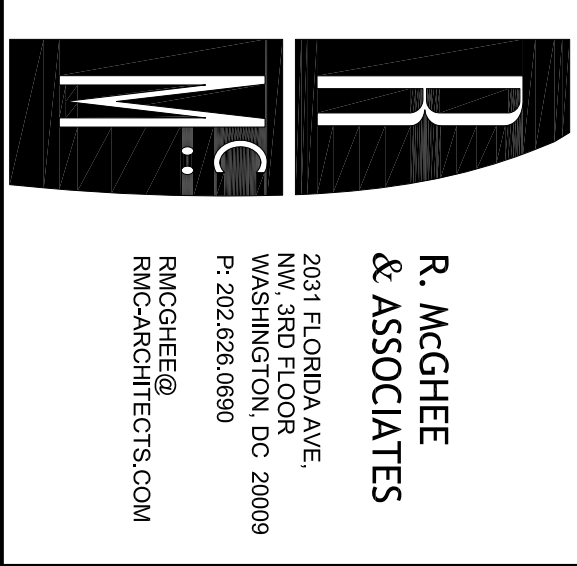

**hord coplan machi**

**HORD COPLAN MACHT**  
2000 DUNE STREET, SUITE 700  
ALEXANDRIA, VA 22314  
P: 571.388.7781

**GENERAL CONTRACTOR:**  
MCN BUILD  
1214 28TH STREET, NW  
WASHINGTON, DC 20007  
P: (202) 535.9424

**MEP:**  
SETTY & ASSOCIATES, LTD.  
3040 WILLIAMS DRIVE, SUITE 600  
FARMAS, VA 22031  
P: (703) 891-2119

**CIVIL:**  
WILES MENSCH CORPORATION  
739 8TH STREET, SE 2ND FLOOR  
WASHINGTON, DC 20003  
P: (202) 699-1941

**TRAILER CONSULTANT:**  
MOBILE MODULAR  
SOLUTIONS  
SUITE 140  
15 CHURCHVILLE ROAD  
WASHINGTON, DC 21014  
P: (800) 944-3442

**MURCH ELEMENTARY SCHOOL  
SWING SPACE**  
4200 CONNECTICUT AVE, NW, WASHINGTON, DC

PROJECT NUMBER:	2016-4248
ISSUE DATE:	ISSUE:
02.08.2016	PRELIMINARY SET
03.15.2016	PERMIT SET

SHEET TITLE:  
**ARCHITECTURAL  
SITE PLAN**

SHEET NUMBER:  
**A0001**

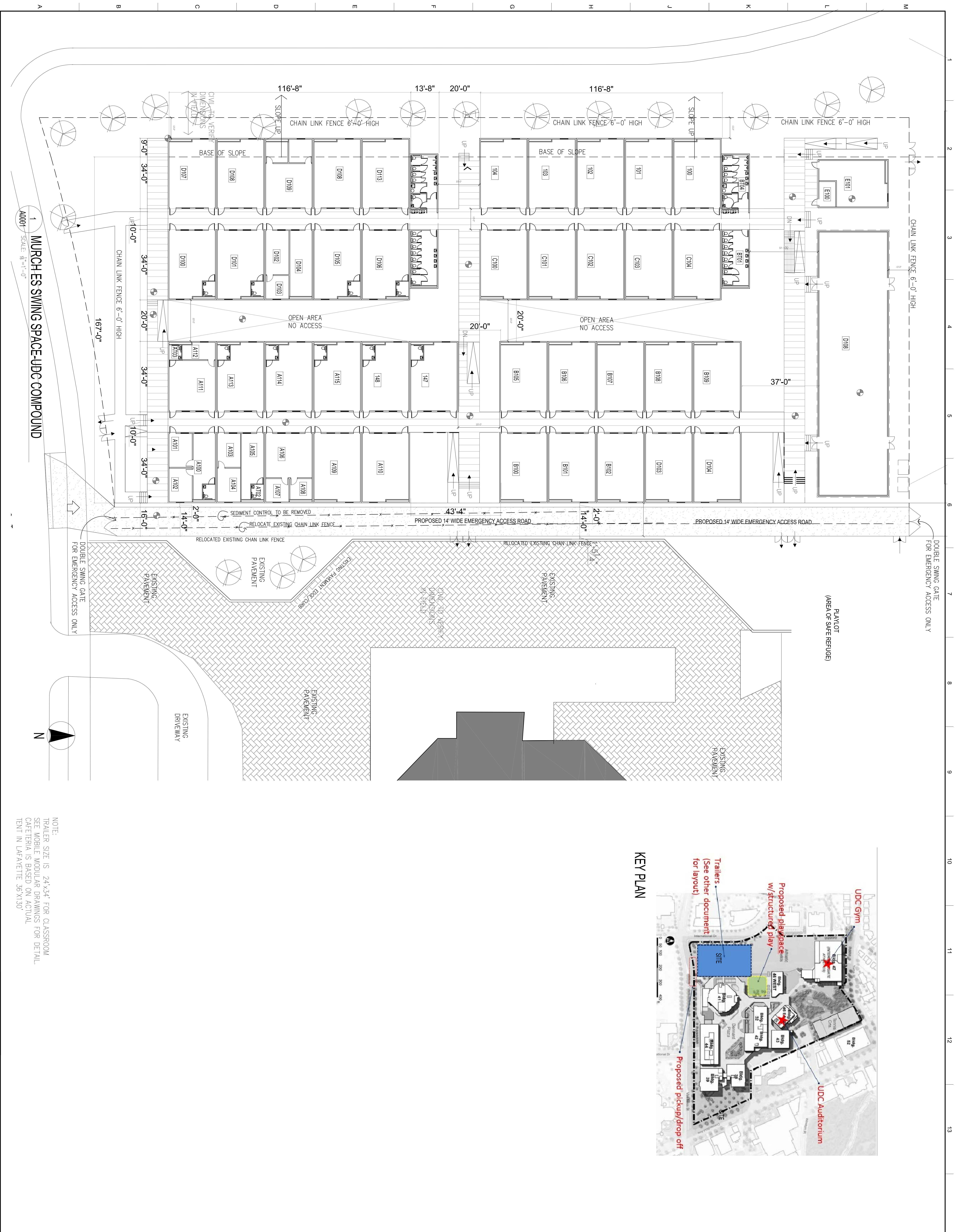

NOTE:  
TRAILER SIZE IS 24'X34' FOR CLASSROOM  
SEE MOBILE MODULAR DRAWINGS FOR DETAIL.  
CAFETERIA IS BASED ON ACTUAL  
TENT IN LAFAYETTE 36 X130